

WEST ELECTRONIC

Obiličeva 15, 37240 Trstenik
069 711 300

KATALOG ELEKTRO MOTORA

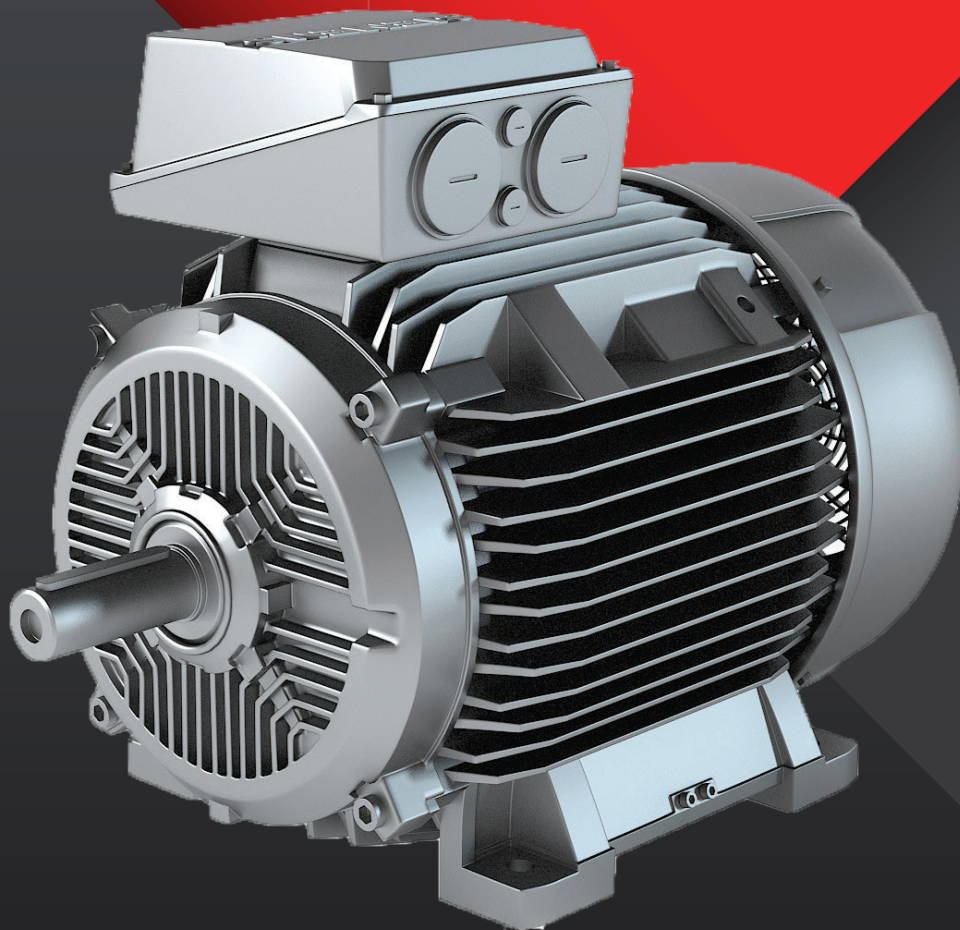



CERTIFICATE OF CONFORMITY OF QUALITY MANAGEMENT SYSTEM CERTIFICATION

NO: 08914Q22361R1M

This Is To Certify That The Quality Management System Of
FANGDA ELECTRIC MACHINE CO.,LTD
Daxi Industrial District, Daxi Town, Wenling City, Zhejiang, China
Code Of Organization:70472402-3 Post Code: 317525

Quality Management System Complies With:

GB/T19001-2008 / ISO9001:2008 Standard

Scope:

Within The Scope Of Production And Service (Three Phase Induction Motor,
Two-value Capacitor Induction Motor, Capacitor Start Asynchronous Motor)

Date of issue: 2014-12-22 Expiry date: 2017-12-21

Holding this certificate organizations receive annual surveillance audits qualified,
And administrative license valid state regulations

Approval of the first
surveillance audit
Zhongshui Brilliant
Certification Co.,Ltd.

Approval of the second
surveillance audit
Zhongshui Brilliant
Certification Co.,Ltd.

Approval of the third
surveillance audit
Zhongshui Brilliant
Certification Co.,Ltd.

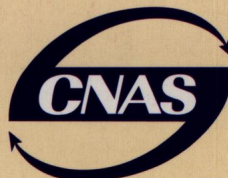

MANAGEMENT SYSTEM



Representative of The Company

CNAS C089-Q

The Certificate Information Can Be Inquired At <http://www.cnca.gov.cn> Or <http://www.zsbc.net>
Tel:010-82272502-8003 Add:Room 7001-7004 Block B Tiancheng Technology Building Of No.2 Xinfeng Street Dewai Avenue Xicheng District Beijing



CERTIFICATE OF CONFORMITY

EU -LOW VOLTAGE DIRECTIVE- 2006/95/EC

Registration NO.: VT09118388

Applicant: ZHEJIANG FANGDA ELECTRIC MOTOR CO., LTD

Applicant Address: DAXI INDUSTRIAL DISTRICT, WENLING CITY, TAIZHOU, ZHEJIANG PROVINCE, CHINA

Product Description: THREE PHASE SERIES (INCLUDING EXPLOSION-PROOF SERIES) INDUCTION MOTOR

Model / Parameters: Y160

Complies with the requirements of the European Community Directive 2006/95/EC. The submitted products have been tested by us with the listed standards and found in compliance with the following European Standards:

EN 60034-1 : 2004 EN 60204-1 : 2006

This certificate of conformity is based on an evaluation of a sample of the above mentioned product. Technical Report and documentation are at the License applicant's disposal. This certificate does not imply assessment of the series-production of the product. The CE markings as shown below can be affixed on the product after preparation of necessary technical documentation.



Authorized by:
Nov 27, 2009

Arunot.
Chief Assessor



VOV CERTIFICATION & TESTING LABORATORY LIMITED

THIS CERTIFICATE REFLECTS THE FINDINGS OF THE TIME AND PLACE OF THE AUDIT
THE CERTIFICATION IS ONLY VALID WITH THE TEST REPORT OR TECHNICAL CONSTRUCTION FILE

Internet site: www.vov.org.uk E-mail: vov@vov.org.uk

Oznaka motora	KW	A	o/min	Ef. %	Faktor snage	Startni obrtni moment	Magnituda uklopne struje	Maksimalan obrtni moment
---------------	----	---	-------	-------	--------------	-----------------------	--------------------------	--------------------------

750r/min

Y2-280M-8	45	94.1	735	92.0	0.79	1.9	6.6	2.0
Y2-315S-8	55	111	735	92.8	0.81	1.8	6.6	2.0
Y2-315M-8	75	151	735	93.0	0.81	1.8	6.6	2.0
Y2-315L1-8	90	178	735	93.8	0.82	1.8	6.6	2.0
Y2-315L2-8	110	217	735	94.0	0.82	1.8	6.4	2.0
Y2-355M1-8	132	261	740	93.7	0.82	1.8	6.4	2.0
Y2-355M2-8	160	315	740	94.2	0.82	1.8	6.4	2.0
Y2-355L-8	200	387	740	94.5	0.83	1.8	6.4	2.0

600r/min

Y2-315S-10	45	99.6	590	91.5	0.75	1.5	6.2	2.0
Y2-315M-10	55	121	590	92.0	0.75	1.5	6.2	2.0
Y2-315L1-10	75	162	590	92.5	0.76	1.5	6.2	2.0
Y2-315L2-10	90	191	590	93.0	0.77	1.5	6.2	2.0
Y2-355M1-10	110	230	590	93.2	0.78	1.3	6.0	2.0
Y2-355M2-10	132	275	590	93.5	0.78	1.3	6.0	2.0
Y2-355L-10	160	333	590	93.5	0.78	1.3	6.0	2.0

B14

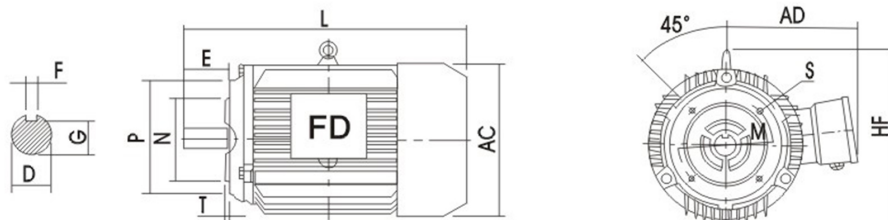

B34

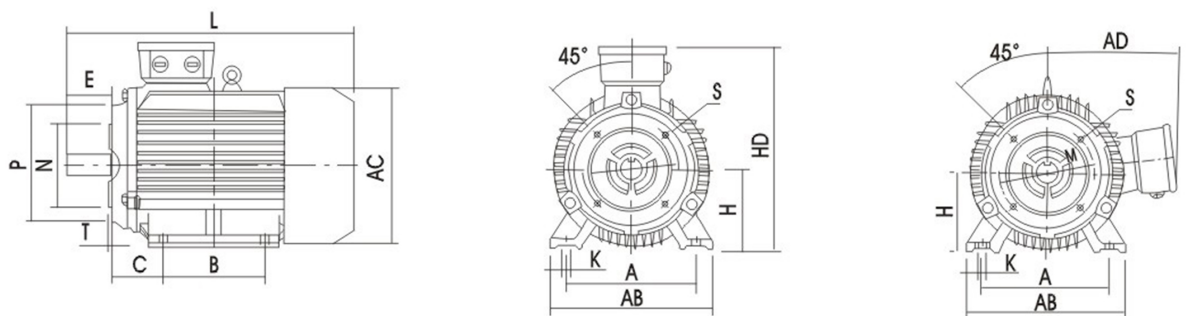

Ram	Polovi	Ugradne dimenzije															Dimenzije motora						
		A	B	C	D	E	F	G	H	M	N	P	R	S	T	K	AB	AC	AD	HD	HF	L	
63M	2.4	110	80	40	11	23	4	8.5	63	75	60	90	0	M5	2.5	7	4	135	130	70	180	130	230
71M	2.4.6	112	90	45	14	30	5	11	71	85	70	105	0	M6	2.5	7	4	150	145	80	195	145	255
80M	2.4.6.8	125	100	50	19	40	6	15.5	80	100	80	120	0	M6	3	10	4	165	175	145	214	185	295
90S	2.4.6.8	140	100	56	24	50	8	20	90	115	95	140	0	M8	3	10	4	180	195	155	250	195	320
90L	2.4.6.8	140	125	56	24	50	8	20	90	115	95	140	0	M8	3	10	4	180	195	155	250	195	345
100L	2.4.6.8	160	140	63	28	60	8	24	100	130	110	160	0	M8	3.5	12	4	205	215	180	270	245	385
112M	2.4.6.8	190	140	70	28	60	8	24	112	130	110	160	0	M8	3.5	12	4	230	240	190	300	265	400

B3

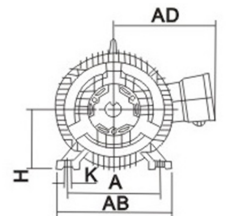
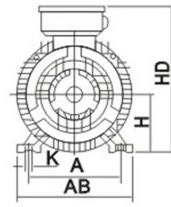
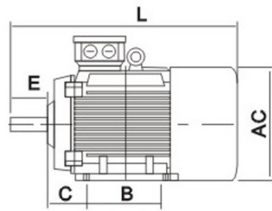
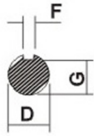

B5

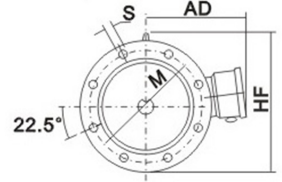
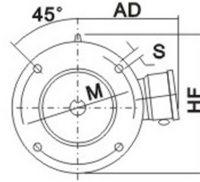
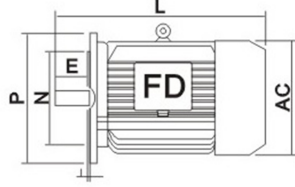

B35

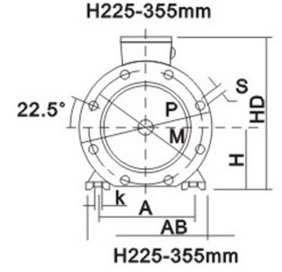
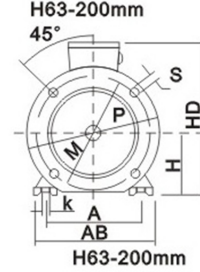
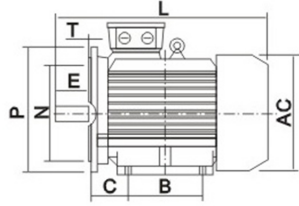

Ram	Polovi	Ugradne dimenzije											Dimenzije motora									
		A	B	C	D	E	F	G	H	M	N	P	R	S	T	K	AB	AC	AD	HD	HF	L
63M	2.4	100	80	40	11	23	4	8.5	63	115	95	140	0	10	3	7	135	130	70	180	130	230
71M	2.4.6	112	90	45	14	30	5	11	71	130	110	160	0	10	3.5	7	150	145	80	195	145	255
80M	2.4.6.8	125	100	50	19	40	6	15.5	80	165	130	200	0	12	3.5	10	165	175	145	220	185	295
90S	2.4.6.8	140	100	56	24	50	8	20	90	165	130	200	0	12	3.5	10	180	195	155	250	195	320
90L	2.4.6.8	140	125	56	24	50	8	20	90	165	130	200	0	12	3.5	10	180	195	155	250	195	345
100L	2.4.6.8	160	140	63	28	60	8	24	100	215	180	250	0	15	4	12	205	215	180	270	245	385
112M	2.4.6.8	190	140	70	28	60	8	24	112	215	180	250	0	15	4	12	230	240	190	300	265	400
132S	2.4.6.8	216	140	89	38	80	10	33	132	265	230	300	0	15	4	12	270	275	210	345	315	470
132M	2.4.6.8	216	178	89	38	80	10	33	132	265	230	300	0	15	4	12	270	275	210	345	315	510
160M	2.4.6.8	254	210	108	42	110	12	37	160	300	250	350	0	19	5	15	320	330	255	420	385	615
160L	2.4.6.8	254	254	108	42	110	12	37	160	300	250	350	0	19	5	15	320	330	255	420	385	670
180M	2.4.6.8	279	241	121	48	110	14	42.5	180	300	250	350	0	19	5	15	355	380	280	455	430	700
180L	2.4.6.8	279	279	121	48	110	14	42.5	180	300	250	350	0	19	5	15	355	380	280	455	430	740
200L	2.4.6.8	318	305	133	55	110	16	49	200	350	300	400	0	19	5	19	395	420	305	505	480	770
225S	4.8	356	286	149	60	140	18	53	225	400	350	450	0	19	5	19	435	470	335	560	535	815
225M	2	356	311	149	55	110	16	49	225	400	350	450	0	19	5	19	435	470	335	560	535	820
	4.6.8				60	140	18	53														845
250M	2	406	349	168	60	140	18	53	250	500	450	550	0	19	5	24	490	510	370	615	595	910
	4.6.8				65	140	18	58														
280S	2	457	368	190	65	140	18	58	280	500	450	550	0	19	5	24	550	580	410	680	650	985
	4.6.8				75	140	20	67.5														
280M	2	457	419	190	65	140	18	58	280	500	450	550	0	24	5	19	550	580	410	680	650	1035
	4.6.8.10				75	140	20	67.5														
315S	2	508	406	216	65	140	18	58	315	600	550	660	0	24	6	28	635	645	530	845	—	1160
	4.6.8.10				80	170	22	71													1270	
315M	2	508	457	216	65	140	18	58	315	600	550	660	0	24	6	28	635	645	530	845	—	1190
	4.6.8.10				80	170	22	71													1300	
315L	2	508	508	216	65	140	18	58	315	600	550	660	0	24	6	28	635	645	530	845	—	1190
	4.6.8.10				80	170	22	71													1300	
355M	2	610	560	254	75	140	20	67.5	355	740	680	800	0	24	6	28	730	710	655	1010	—	1500
	4.6.8.10				95	170	25	86													1530	
355L	2	610	630	254	75	140	20	67.5	355	740	680	800	0	24	6	28	730	710	655	1010	—	1500
	4.6.8.10				95	170	25	86													1530	

Oznaka motora	KW	A	o/min	Ef. %	Faktor snage	Startni obrtni moment	Magnituda uklopne struje	Maksimalan obrtni moment
3000r/min								
Y2-250M-2	55	100	2965	92.5	0.90	2.0	7.5	2.3
Y2-280S-2	75	135	2970	93.0	0.90	2.0	7.5	2.3
Y2-280M-2	90	160	2970	93.8	0.91	2.0	7.5	2.3
Y2-315S-2	110	195	2975	94.0	0.91	1.8	7.1	2.2
Y2-315M-2	132	233	2975	94.5	0.91	1.8	7.1	2.2
Y2-315L1-2	160	279	2975	94.6	0.92	1.8	7.1	2.2
Y2-315L2-2	200	348	2975	94.8	0.92	1.8	7.1	2.2
Y2-355M-2	250	433	2980	95.3	0.92	1.6	7.1	2.2
Y2-355L-2	315	544	2980	95.6	0.92	1.6	7.1	2.2
1500r/min								
Y2-63M1-4	0.12	0.44	1310	57.0	0.72	2.1	4.4	2.2
Y2-63M2-4	0.18	0.62	1310	60.0	0.73	2.1	4.4	2.2
Y2-71M1-4	0.25	0.79	1330	65.0	0.74	2.1	5.2	2.2
Y2-71M2-4	0.37	1.12	1330	67.0	0.75	2.1	5.2	2.2
Y2-80M1-4	0.55	1.6	1390	71.0	0.75	2.4	5.2	2.3
Y2-80M2-4	0.75	2.0	1390	73.0	0.76	2.3	6.0	2.3
Y2-90S-4	1.1	2.9	1390	75.0	0.77	2.3	6.0	2.3
Y2-90L-4	1.5	3.7	1390	78.0	0.79	2.3	6.0	2.3
Y2-100L1-4	2.2	5.2	1410	80.0	0.81	2.3	7.0	2.3
Y2-100L2-4	3	6.8	1410	82.0	0.82	2.3	7.0	2.3
Y2-112M-4	4	8.8	1440	84.0	0.82	2.3	7.0	2.3
Y2-132S-4	5.5	11.8	1440	85.0	0.83	2.3	7.0	2.3
Y2-132M-4	7.5	15.6	1440	87.0	0.84	2.3	7.0	2.3
Y2-160M-4	11	22.3	1460	88.0	0.84	2.2	7.0	2.3
Y2-160L-4	15	30.1	1460	89.0	0.85	2.2	7.5	2.3
Y2-180M-4	18.5	36.1	1470	90.5	0.86	2.2	7.5	2.3
Y2-180L-4	22	42.7	1470	91.0	0.86	2.2	7.5	2.3
Y2-200L-4	30	57.6	1470	92.0	0.86	2.2	7.2	2.3
Y2-225S-4	37	69.9	1475	92.5	0.87	2.2	7.2	2.3
Y2-225M-4	45	84.7	1475	92.8	0.87	2.2	7.2	2.3
Y2-250M-4	55	103	1480	93.0	0.87	2.2	7.2	2.3
Y2-280S-4	75	140	1480	93.8	0.87	2.2	7.2	2.3
Y2-280M-4	90	167	1480	94.2	0.87	2.2	7.2	2.3
Y2-315S-4	110	201	1480	94.5	0.88	2.1	6.9	2.2
Y2-315M-4	132	240	1480	94.8	0.88	2.1	6.9	2.2
Y2-315L1-4	160	288	1480	94.9	0.89	2.1	6.9	2.2
Y2-315L2-4	200	359	1480	95.0	0.89	2.1	6.9	2.2
Y2-355M-4	250	443	1490	95.3	0.90	2.1	6.9	2.2
Y2-355L-4	315	556	1490	95.6	0.90	2.1	6.9	2.2
1000r/min								
Y2-71M1-6	0.18	0.74	850	56.0	0.66	1.9	4.0	2.0
Y2-71M2-6	0.25	0.95	850	59.0	0.68	1.9	4.0	2.0
Y2-80M1-6	0.37	1.3	885	62.0	0.70	1.9	4.7	2.0

Oznaka motora	KW	A	o/min	Ef. %	Faktor snage	Startni obrtni moment	Magnituda uklopne struje	Maksimalan obrtni moment
1000r/min								
Y2-80M2-6	0.55	1.8	885	65.0	0.72	1.9	4.7	2.1
Y2-90S-6	0.75	2.3	910	69.0	0.72	2.0	5.5	2.1
Y2-90L-6	1.1	3.2	910	72.0	0.73	2.0	5.5	2.1
Y2-100L-6	1.5	3.9	920	76.0	0.75	2.0	5.5	2.1
Y2-112M-6	2.2	5.6	935	79.0	0.76	2.0	6.5	2.1
Y2-132S-6	3	7.4	960	81.0	0.76	2.1	6.5	2.1
Y2-132M1-6	4	9.8	960	82.0	0.76	2.1	6.5	2.1
Y2-132M2-6	5.5	12.9	965	84.0	0.77	2.1	6.5	2.1
Y2-160M-6	7.5	17.2	970	86.0	0.77	2.0	6.5	2.1
Y2-160L-6	11	24.2	970	87.5	0.78	2.0	6.5	2.1
Y2-180M-6	15	31.6	970	89.0	0.81	2.0	7.0	2.1
Y2-200L1-6	18.5	38.6	980	90.0	0.81	2.1	7.0	2.1
Y2-200L2-6	22	44.7	980	90.0	0.83	2.1	7.0	2.1
Y2-225M-6	30	59.3	980	91.5	0.84	2.0	7.0	2.1
Y2-250M-6	37	71.1	980	92.0	0.86	2.1	7.0	2.1
Y2-280S-6	45	85.9	980	92.5	0.86	2.1	7.0	2.0
Y2-280M-6	55	105	980	92.8	0.86	2.1	7.0	2.0
Y2-315S-6	75	142	985	93.5	0.86	2.0	7.0	2.0
Y2-315M-6	90	170	985	92.8	0.86	2.0	7.0	2.0
Y2-315L1-6	110	207	985	94.0	0.86	2.0	6.7	2.0
Y2-315L2-6	132	245	985	94.2	0.87	2.0	6.7	2.0
Y2-355M1-6	160	292	990	94.5	0.88	1.9	6.7	2.0
Y2-355M2-6	200	365	990	94.7	0.88	1.9	6.7	2.0
Y2-355L-6	250	455	990	94.9	0.88	1.9	6.7	2.0
750r/min								
Y2-80M1-8	0.18	0.88	645	51.0	0.61	1.8	3.3	1.9
Y2-80M2-8	0.25	1.15	645	54.0	0.61	1.8	3.3	1.9
Y2-90S-8	0.37	1.49	670	62.0	0.61	1.8	4.0	1.9
Y2-90L-8	0.55	2.17	670	63.0	0.61	1.8	4.0	2.0
Y2-100L1-8	0.75	2.4	680	71.0	0.67	1.8	4.0	2.0
Y2-100L2-8	1.1	3.4	680	73.0	0.69	1.8	5.0	2.0
Y2-112M-8	1.5	4.4	690	75.0	0.69	1.8	5.0	2.0
Y2-132S-8	2.2	6	705	78.0	0.71	1.8	6.0	2.0
Y2-132M-8	3	7.9	705	79.0	0.73	1.8	6.0	2.0
Y2-160M1-8	4	10.3	720	81.0	0.73	1.9	6.0	2.0
Y2-160M2-8	5.5	13.6	720	83.0	0.74	2.0	6.0	2.0
Y2-160L-8	7.5	17.8	720	85.5	0.75	2.0	6.0	2.0
Y2-180L-8	11	25.1	730	87.5	0.76	2.0	6.6	2.0
Y2-200L-8	15	34.1	730	88.0	0.76	2.0	6.6	2.0
Y2-225S-8	18.5	41.4	730	90.0	0.76	1.9	6.6	2.0
Y2-225M-8	22	47.4	730	90.5	0.78	1.9	6.6	2.0
Y2-250M-8	30	63.4	730	91.0	0.79	1.9	6.6	2.0
Y2-280S-8	37	77.8	740	91.5	0.79	1.9	6.6	2.0

Oznaka motora	KW	A	o/min	Ef. %	Faktor snage	Startni obrtni moment	Magnituda uklopne struje	Maksimalan obrtni moment
3000r/min								
Y2-63M1-2	0.18	0.53	2720	65.0	0.80	2.2	5.5	2.2
Y2-63M2-2	0.25	0.69	2720	68.0	0.81	2.2	5.5	2.2
Y2-71M1-2	0.37	0.99	2740	70.0	0.81	2.2	6.1	2.2
Y2-71M2-2	0.55	1.4	2740	73.0	0.82	2.2	6.1	2.3
Y2-80M1-2	0.75	1.8	2840	75.0	0.83	2.2	6.1	2.3
Y2-80M2-2	1.1	2.6	2840	77.0	0.84	2.2	7.0	2.3
Y2-90S-2	1.5	3.4	2845	79.0	0.84	2.2	7.0	2.3
Y2-90L-2	2.2	4.9	2845	81.0	0.85	2.2	7.0	2.3
Y2-100L-2	3	6.3	2860	83.0	0.87	2.2	7.5	2.3
Y2-112M-2	4	8.1	2880	85.0	0.88	2.2	7.5	2.3
Y2-132S1-2	5.5	11.0	2900	86.0	0.88	2.2	7.5	2.3
Y2-132S2-2	7.5	14.9	2900	87.0	0.88	2.2	7.5	2.3
Y2-160M1-2	11	21.3	2930	88.0	0.89	2.2	7.5	2.3
Y2-160M2-2	15	28.8	2930	89.0	0.89	2.2	7.5	2.3
Y2-160L-2	18.5	34.7	2930	90.0	0.90	2.2	7.5	2.3
Y2-180M-2	22	41.0	2940	90.0	0.90	2.0	7.5	2.3
Y2-200L1-2	30	55.5	2950	91.2	0.90	2.0	7.5	2.3
Y2-200L2-2	37	67.9	2950	92.0	0.90	2.0	7.5	2.3
Y2-225M-2	45	82.3	2960	92.3	0.90	2.0	7.5	2.3

Oznaka motora	KW	A	o/min	Ef. %	Faktor snage	Startni obrtni moment	Magnituda uklopne struje	Maksimalan obrtni moment
3000r/min								
Y2-250M-2	55	100	2965	92.5	0.90	2.0	7.5	2.3
Y2-280S-2	75	135	2970	93.0	0.90	2.0	7.5	2.3
Y2-280M-2	90	160	2970	93.8	0.91	2.0	7.5	2.3
Y2-315S-2	110	195	2975	94.0	0.91	1.8	7.1	2.2
Y2-315M-2	132	233	2975	94.5	0.91	1.8	7.1	2.2
Y2-315L1-2	160	279	2975	94.6	0.92	1.8	7.1	2.2
Y2-315L2-2	200	348	2975	94.8	0.92	1.8	7.1	2.2
Y2-355M-2	250	433	2980	95.3	0.92	1.6	7.1	2.2
Y2-355L-2	315	544	2980	95.6	0.92	1.6	7.1	2.2
1500r/min								
Y2-63M1-4	0.12	0.44	1310	57.0	0.72	2.1	4.4	2.2
Y2-63M2-4	0.18	0.62	1310	60.0	0.73	2.1	4.4	2.2
Y2-71M1-4	0.25	0.79	1330	65.0	0.74	2.1	5.2	2.2
Y2-71M2-4	0.37	1.12	1330	67.0	0.75	2.1	5.2	2.2
Y2-80M1-4	0.55	1.6	1390	71.0	0.75	2.4	5.2	2.3
Y2-80M2-4	0.75	2.0	1390	73.0	0.76	2.3	6.0	2.3
Y2-90S-4	1.1	2.9	1390	75.0	0.77	2.3	6.0	2.3
Y2-90L-4	1.5	3.7	1390	78.0	0.79	2.3	6.0	2.3
Y2-100L1-4	2.2	5.2	1410	80.0	0.81	2.3	7.0	2.3
Y2-100L2-4	3	6.8	1410	82.0	0.82	2.3	7.0	2.3
Y2-112M-4	4	8.8	1440	84.0	0.82	2.3	7.0	2.3
Y2-132S-4	5.5	11.8	1440	85.0	0.83	2.3	7.0	2.3
Y2-132M-4	7.5	15.6	1440	87.0	0.84	2.3	7.0	2.3
Y2-160M-4	11	22.3	1460	88.0	0.84	2.2	7.0	2.3
Y2-160L-4	15	30.1	1460	89.0	0.85	2.2	7.5	2.3
Y2-180M-4	18.5	36.1	1470	90.5	0.86	2.2	7.5	2.3
Y2-180L-4	22	42.7	1470	91.0	0.86	2.2	7.5	2.3
Y2-200L-4	30	57.6	1470	92.0	0.86	2.2	7.2	2.3
Y2-225S-4	37	69.9	1475	92.5	0.87	2.2	7.2	2.3
Y2-225M-4	45	84.7	1475	92.8	0.87	2.2	7.2	2.3
Y2-250M-4	55	103	1480	93.0	0.87	2.2	7.2	2.3
Y2-280S-4	75	140	1480	93.8	0.87	2.2	7.2	2.3
Y2-280M-4	90	167	1480	94.2	0.87	2.2	7.2	2.3
Y2-315S-4	110	201	1480	94.5	0.88	2.1	6.9	2.2
Y2-315M-4	132	240	1480	94.8	0.88	2.1	6.9	2.2
Y2-315L1-4	160	288	1480	94.9	0.89	2.1	6.9	2.2
Y2-315L2-4	200	359	1480	95.0	0.89	2.1	6.9	2.2
Y2-355M-4	250	443	1490	95.3	0.90	2.1	6.9	2.2
Y2-355L-4	315	556	1490	95.6	0.90	2.1	6.9	2.2
1000r/min								
Y2-71M1-6	0.18	0.74	850	56.0	0.66	1.9	4.0	2.0
Y2-71M2-6	0.25	0.95	850	59.0	0.68	1.9	4.0	2.0
Y2-80M1-6	0.37	1.3	885	62.0	0.70	1.9	4.7	2.0

Oznaka motora	KW	A	o/min	Ef. %	Faktor snage	Startni obrtni moment	Magnituda uklopne struje	Maksimalan obrtni moment
3000r/min								
Y2-250M-2	55	100	2965	92.5	0.90	2.0	7.5	2.3
Y2-280S-2	75	135	2970	93.0	0.90	2.0	7.5	2.3
Y2-280M-2	90	160	2970	93.8	0.91	2.0	7.5	2.3
Y2-315S-2	110	195	2975	94.0	0.91	1.8	7.1	2.2
Y2-315M-2	132	233	2975	94.5	0.91	1.8	7.1	2.2
Y2-315L1-2	160	279	2975	94.6	0.92	1.8	7.1	2.2
Y2-315L2-2	200	348	2975	94.8	0.92	1.8	7.1	2.2
Y2-355M-2	250	433	2980	95.3	0.92	1.6	7.1	2.2
Y2-355L-2	315	544	2980	95.6	0.92	1.6	7.1	2.2
1500r/min								
Y2-63M1-4	0.12	0.44	1310	57.0	0.72	2.1	4.4	2.2
Y2-63M2-4	0.18	0.62	1310	60.0	0.73	2.1	4.4	2.2
Y2-71M1-4	0.25	0.79	1330	65.0	0.74	2.1	5.2	2.2
Y2-71M2-4	0.37	1.12	1330	67.0	0.75	2.1	5.2	2.2
Y2-80M1-4	0.55	1.6	1390	71.0	0.75	2.4	5.2	2.3
Y2-80M2-4	0.75	2.0	1390	73.0	0.76	2.3	6.0	2.3
Y2-90S-4	1.1	2.9	1390	75.0	0.77	2.3	6.0	2.3
Y2-90L-4	1.5	3.7	1390	78.0	0.79	2.3	6.0	2.3
Y2-100L1-4	2.2	5.2	1410	80.0	0.81	2.3	7.0	2.3
Y2-100L2-4	3	6.8	1410	82.0	0.82	2.3	7.0	2.3
Y2-112M-4	4	8.8	1440	84.0	0.82	2.3	7.0	2.3
Y2-132S-4	5.5	11.8	1440	85.0	0.83	2.3	7.0	2.3
Y2-132M-4	7.5	15.6	1440	87.0	0.84	2.3	7.0	2.3
Y2-160M-4	11	22.3	1460	88.0	0.84	2.2	7.0	2.3
Y2-160L-4	15	30.1	1460	89.0	0.85	2.2	7.5	2.3
Y2-180M-4	18.5	36.1	1470	90.5	0.86	2.2	7.5	2.3
Y2-180L-4	22	42.7	1470	91.0	0.86	2.2	7.5	2.3
Y2-200L-4	30	57.6	1470	92.0	0.86	2.2	7.2	2.3
Y2-225S-4	37	69.9	1475	92.5	0.87	2.2	7.2	2.3
Y2-225M-4	45	84.7	1475	92.8	0.87	2.2	7.2	2.3
Y2-250M-4	55	103	1480	93.0	0.87	2.2	7.2	2.3
Y2-280S-4	75	140	1480	93.8	0.87	2.2	7.2	2.3
Y2-280M-4	90	167	1480	94.2	0.87	2.2	7.2	2.3
Y2-315S-4	110	201	1480	94.5	0.88	2.1	6.9	2.2
Y2-315M-4	132	240	1480	94.8	0.88	2.1	6.9	2.2
Y2-315L1-4	160	288	1480	94.9	0.89	2.1	6.9	2.2
Y2-315L2-4	200	359	1480	95.0	0.89	2.1	6.9	2.2
Y2-355M-4	250	443	1490	95.3	0.90	2.1	6.9	2.2
Y2-355L-4	315	556	1490	95.6	0.90	2.1	6.9	2.2
1000r/min								
Y2-71M1-6	0.18	0.74	850	56.0	0.66	1.9	4.0	2.0
Y2-71M2-6	0.25	0.95	850	59.0	0.68	1.9	4.0	2.0
Y2-80M1-6	0.37	1.3	885	62.0	0.70	1.9	4.7	2.0